

SINGER
591V200,V300

Form U3660(786)
Part No. 379049-002
Printed in Japan

MACHINE PARTS CHART **for** **SINGER***

591 v200

591 v300

SINGER*

591 V200/300

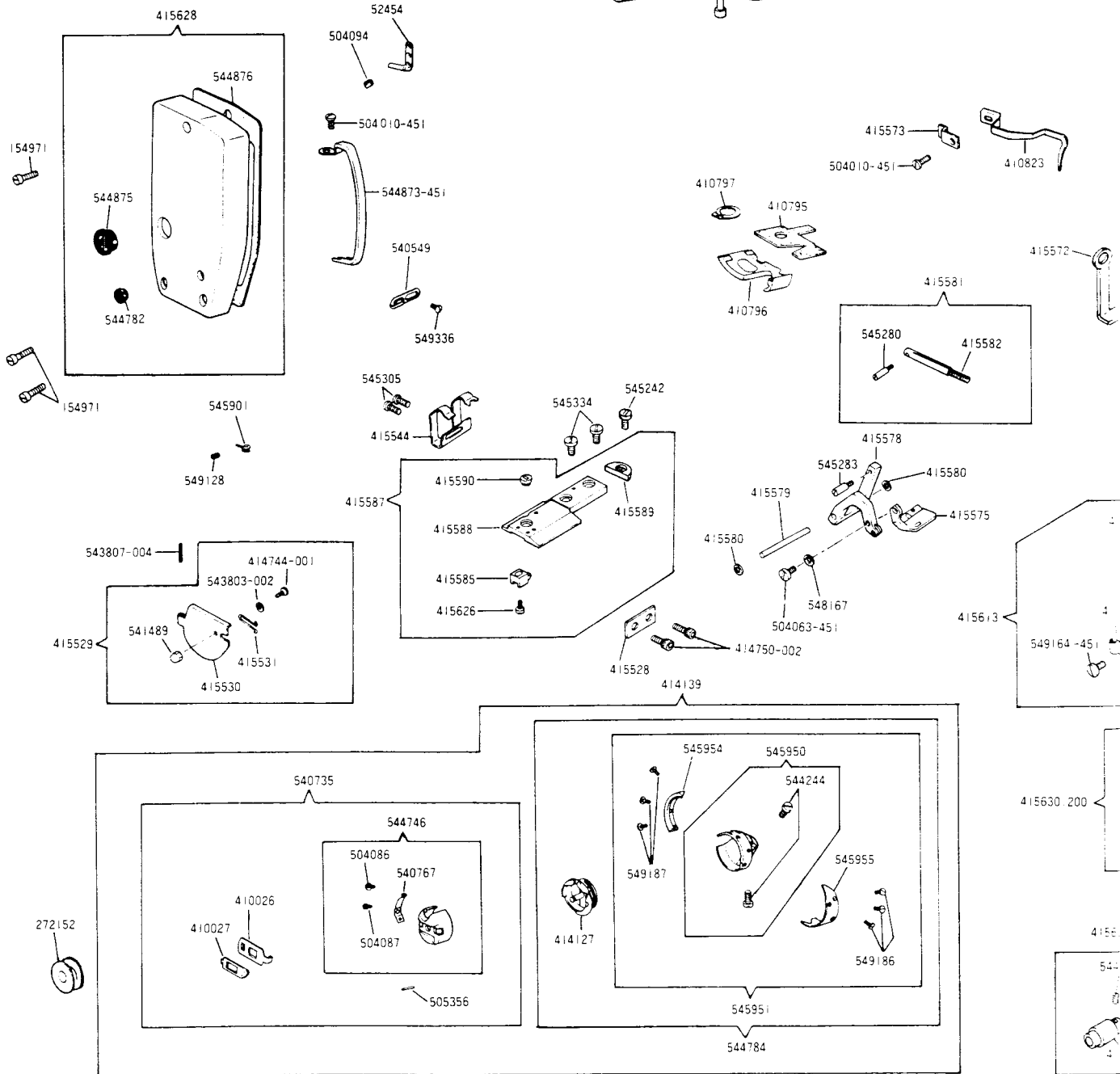
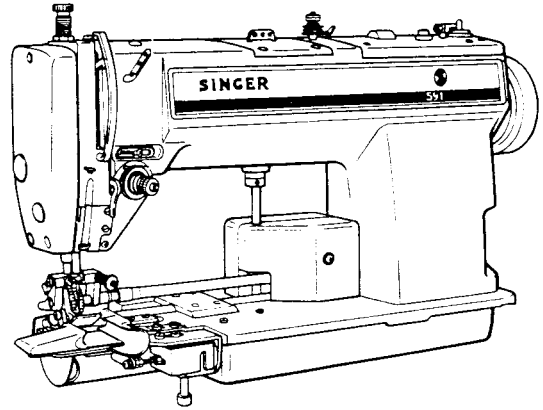

with U.T.T. same Hook as 591D. U.T.T.
is used. i.e. P/N. 544784

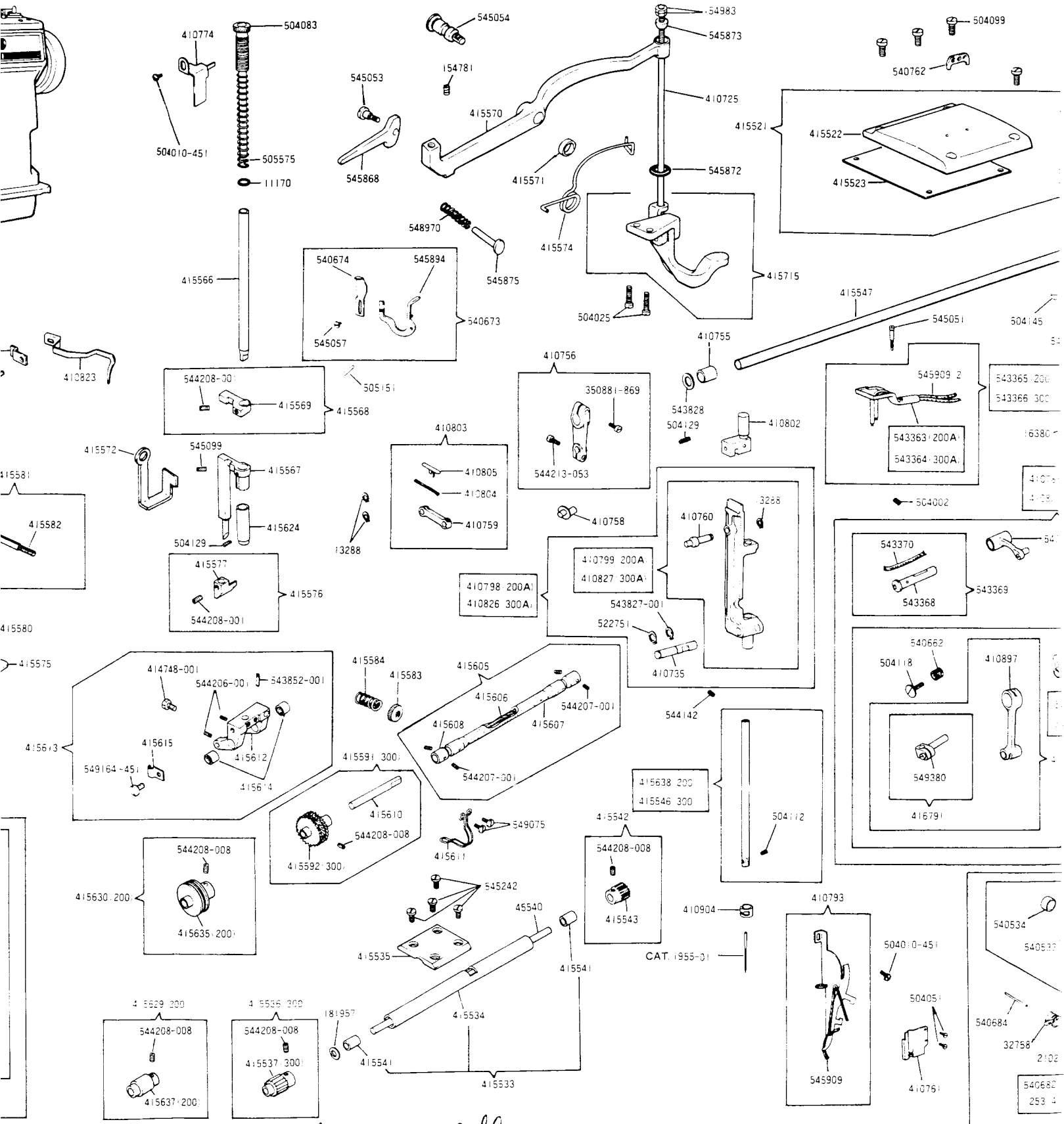

110. U.T.T.

optional knurled rollers.
 Top. 415736
 Bottom. 417737.

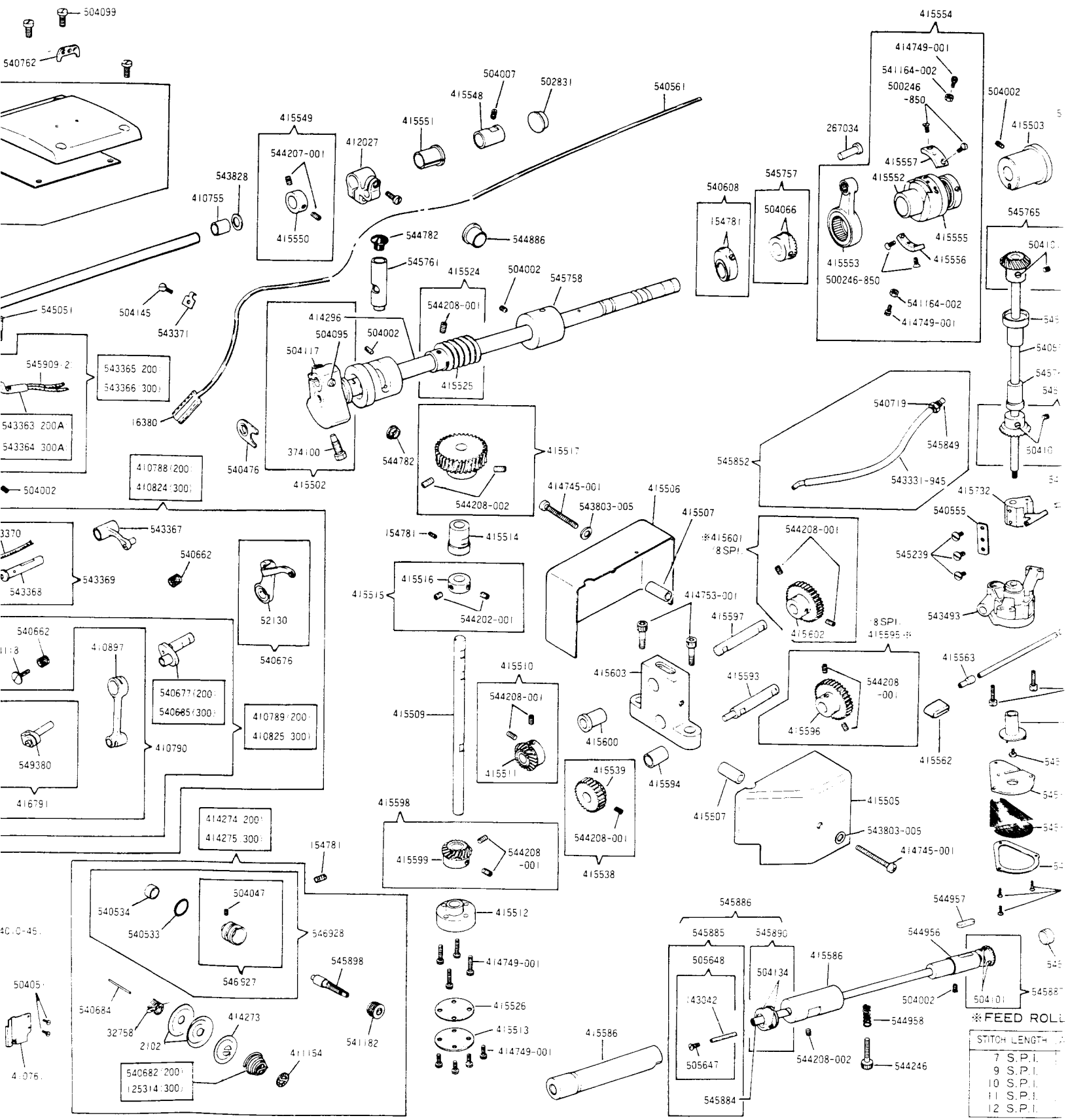

※ FEED ROLL

7 S.P.I.
9 S.P.I.
10 S.P.I.
11 S.P.I.
12 S.P.I.

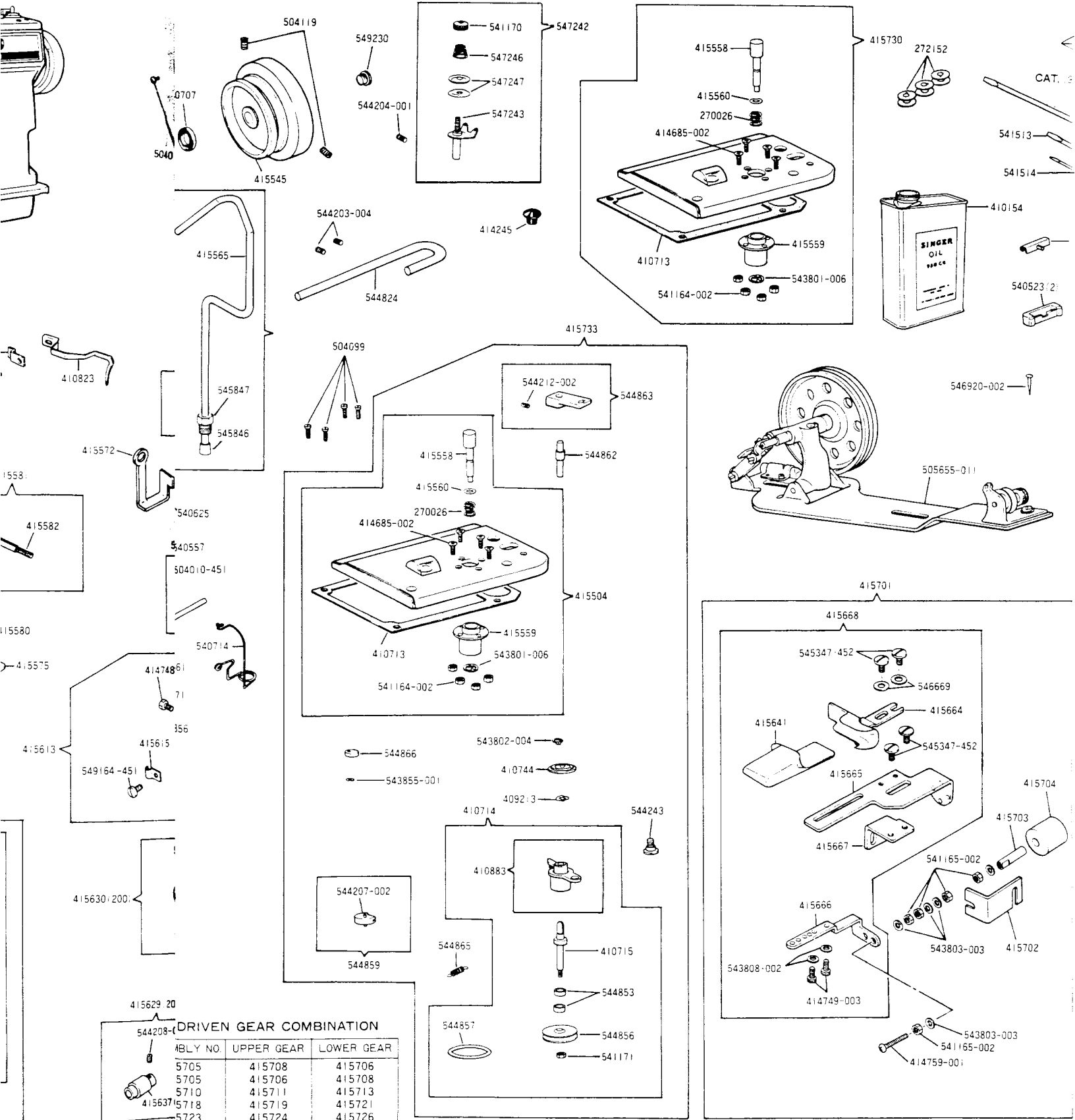

DRIVEN GEAR COMBINATION

MBLY NO.	UPPER GEAR	LOWER GEAR
5705	415708	415706
5705	415706	415708
5710	415711	415713
5718	415719	415721
5723	415724	415726



CAT. 1955-01

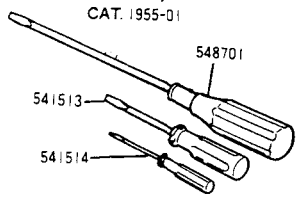

410154

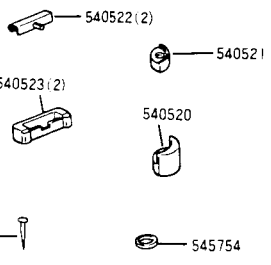

546920-002

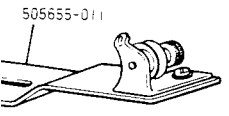

505655-011

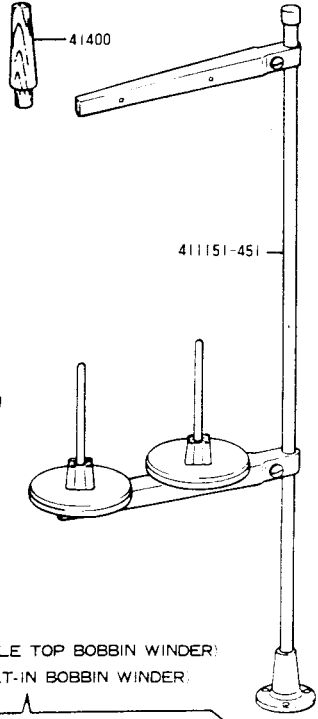

411151-451

414260 FOR TABLE TOP BOBBIN WINDER:
410769 FOR BUILT-IN BOBBIN WINDER:

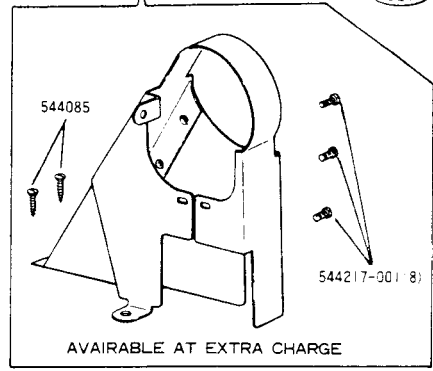

AVAILABLE AT EXTRA CHARGE

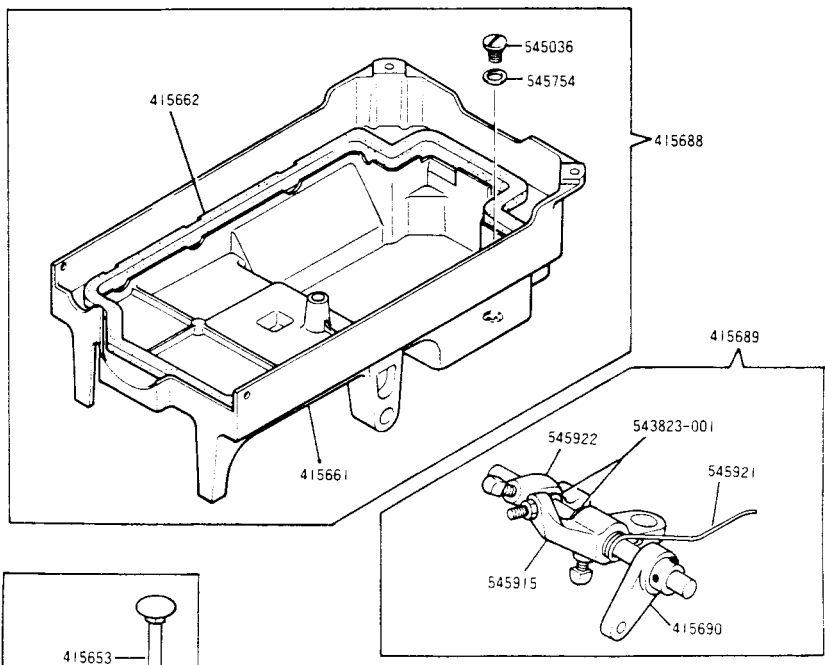

415662

415688

415689

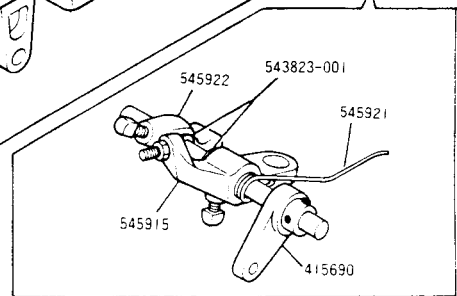

545915

543823-001

545921

415690

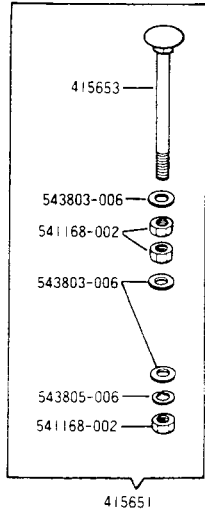

415653

543803-006

541168-002

543803-006

543805-006

541168-002

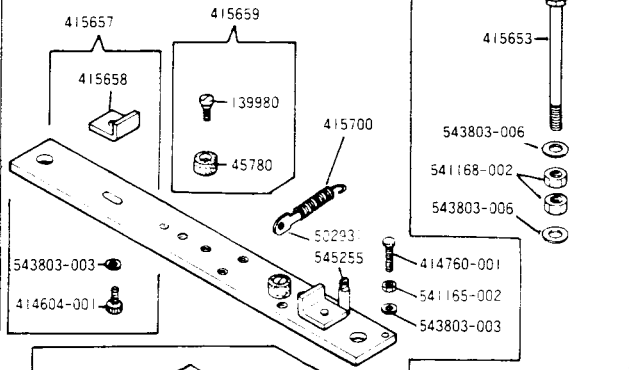

415657

415659

415658

139980

45780

415700

50293

545255

543803-003

414604-001

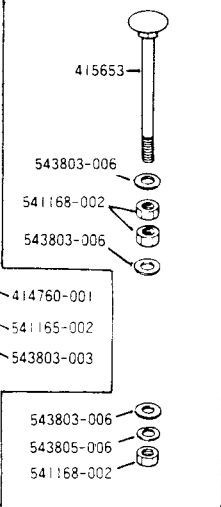

415653

543803-006

541168-002

543803-006

414760-001

541165-002

543803-003

543803-006

543805-006

541168-002

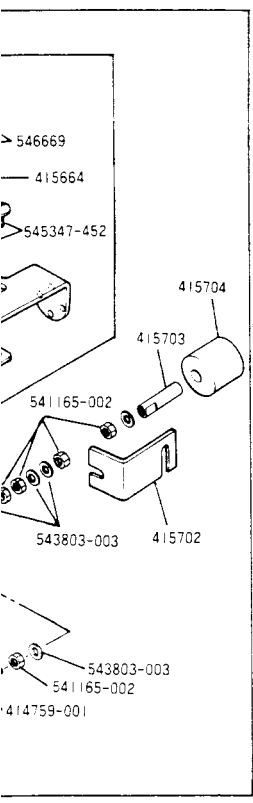

546669

415664

545347-452

415704

415703

541165-002

543803-003

415702

543803-003

541165-002

414759-001

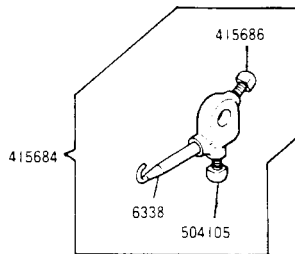

415686

415684

6338

504105



415674

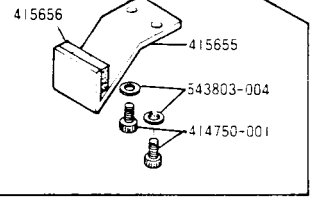

415656

415655

415654

543803-004

414750-001

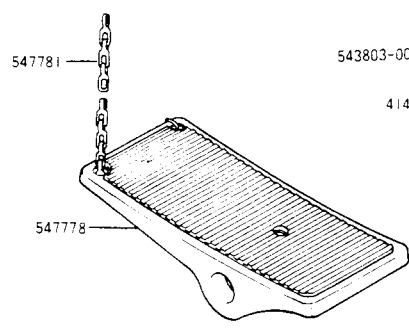

547781

547778

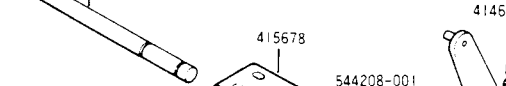

415678

543803-004

414750-001

543810-003

415682

414604

543803-003

544208-001

415695

503000

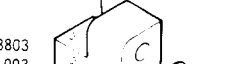

415698

543801-001

504105

544895

414115

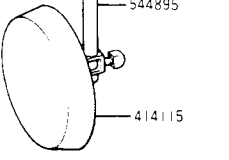

414115